



Instant Swab Total Protein (Cat.# M2401)

For the Quick Detection of Protein

50 tests

For Research or Laboratory Use Only
Not for Use in Diagnostic Procedures
Please read full descriptions in this manual before use

Supplied by:
Morinaga Institute of Biological Science, Inc. (MIoBS)
2-1-16 Sachiura, Kanazawa-ku, Yokohama 236-0003, Japan
E-mail: info_miobs_e@morinaga.co.jp
Website: https://www.miobs-e.com

Storage conditions and Expiry of kit

1. Store the Test Pouch in the storage bag. The yellow reagent in this product will fade and become less reactive when exposed to light. Do not use the Test Pouch with the faded color reagent.
2. Keep the storage bag at 4–25°C (39–77°F) in a darkened place, but DO NOT FREEZE!
3. Do not use the Test Pouch after the expiration date indicated on the storage bag.

Warnings

1. Do not use this product in the presence of naked flames. The yellow reagent in this product is a flammable liquid.
2. Strictly avoid contact with the yellow reagent. In case of contact, immediately wash the affected area with a lot of water, and seek medical attention if necessary. In case of ingestion, call the poison control center and obtain first aid treatment.
3. Pressing hard on the reagent part may cause the yellow reagent to leak.
4. Dispose of the product immediately after use to prevent the yellow reagent from flowing out.

1. Intended Use

Instant Swab Total Protein is intended for a quick detection of proteins on environmental surfaces like cookware and production lines after cleaning.

NOTE: For testing proteins of particular allergenic ingredients, use Rapid Test Easy, Rapid Test Pro II, or Food Allergen ELISA kit II.

2. Description of the Product

- A qualitative test in colorimetric method format for visual detection
- A simple sample preparation procedure
- Provide test results in a moment
- Performance characteristic of this product is shown in Table1

Table1. Performance characteristic in Instant Swab Total Protein

Limit of detection	10 µg proteins (The threshold was determined with bovine serum albumin)
--------------------	--

3. Kit Component

Component	Amount
Test Pouch	50 packs (1 Test swab/ pack)

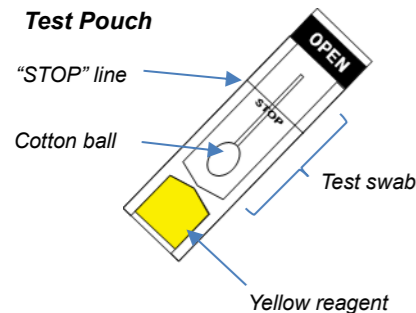

Fig1. Component

4. Test Procedure

Precautions

- ✓ Open the Test Pouch just before use.
- ✓ Do not touch the cotton ball and the base of it with bare hands.
- ✓ If there is a lot of water in the wiping area, allow it to dry or be slightly damp before wiping it off.

Test Procedure

1. Open the top of the Test Pouch to the "STOP" line and take out the Test swab (Fig. 2(a)).
2. Wipe the inspection area well with the cotton ball of the Test swab (Fig. 2(b)). If wiping off a dry area, wet the cotton ball with a drop of water before wiping it off.
3. Put the wiped-off Test swab back into the bag and stick the divider through (see dotted line in Fig. 2(c)).
4. Let the cotton ball soak in the yellow reagent (Fig. 2(d)).

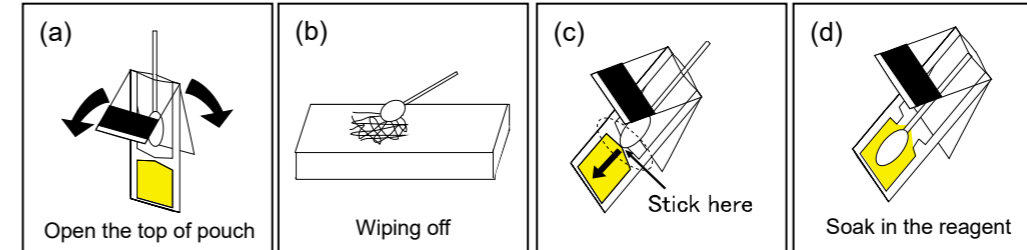

Fig2. Test steps

(a) Opening the pouch, (b) Surface swabbing, (c) Sticking the divider through, (d) Soaking in the reagent

5. Results

Immediately interpret the results appearing on the cotton ball, such as described below.

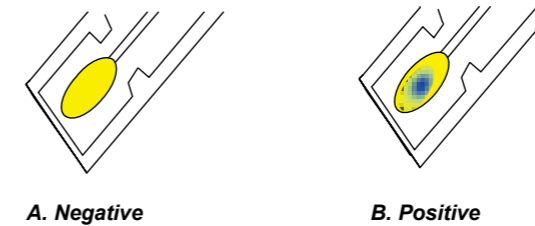

Fig3. Interpretation of results

- A) Negative: No color change on the cotton ball of the Test swab.
- B) Positive: The cotton ball of the Test swab turns green/ blue.

NOTE: Regardless of the presence or absence of proteins, the yellow reagent reacts with water and may change color temporarily. This discoloration caused by water will disappear when the reagent is mixed well with water by rubbing the cotton ball gently by hand.

6. Warranty

Morinaga Institute of Biological Science, Inc. makes no warranty of any kind, either expressed or implied, except that the materials from which its products are made are of standard quality. Buyer assumes all risk and liability resulting from the use of this product. There is no warranty of merchantability of the product, or of the fitness of the product for any purpose. Morinaga Institute of Biological Science, Inc. agrees to replace any defective product, but expressly disclaims liability for damages, including special or consequential damage, or expenses arising directly or indirectly from the use of this product.